



VARIABLE FREQUENCY DRIVE (VFD) PORTABLE CONTROL STATION



Dimensions:

Length x Width x Height:	23.3ft x 12ft x 8.5ft (7m x 3.7m x 2.6m)
Length x Width x Height (Transp.):	20ft x 12ft x 8.5ft (6m x 3.7m x 2.6m)
Weight (Dry):	22,046lbs (10,000kg)



The TESCO Variable Frequency Drive (VFD) Portable Control Station is designed for electrical AC-driven top drives. This station provides the operator with a state of the art top drive control system that complies with Europe's highest safety standards and certifications to provide a safe, smooth and user friendly operation that can be manual, automatic, local or remote.

The container is listed as a A60 Certified Building Manufactured to Zone 1 CE ATEX Standards which allows internal loading at a remote site due to weight restrictions for some offshore cranes for single lifts. This certified container can be used for multiple purposes in offshore / hazardous environments and has the capability of being converted for other applications – i.e. mud logging unit.

The VFD Control Station is CE ATEX certified and contains air locked doors, a blower, pressure sensors and an alarm to meet Zone 1 Classification standards and E-purging requirements. Both the AC-Drive and PLC have been mounted into the portable housing. A termination board and multi transits connect incoming/ outgoing utility loops and internal wiring is permanently housed. Climate control for all environmental conditions is maintained by the installed air conditioning unit which is designed with 80% redundancy. The control station's lifting lugs allow for easy vertical and horizontal lifting and handling.

Area Classification	Hazardous Area Zone 1
Design Temperature	-4° F to 113° F (-20° C to 45° C)
Certifying Agency	DNV
Standard	CE ATEX
Electrical Compliance Codes	IEC 60364 (VDE 0100) / IEC 60664 (VDE 0110) / DIN VDE 0106 / IEC 60204 (DIN VDE 0113 Part 1) / IEC 60079-13
Directives -Low Voltage	EN 50178 / DIN VDE 0160 in conjunction with EN 60439-1 / VDE 0660 Part 500 / EN 60146 / VDE 0558
-EMC	89 / 336 / EEC
Power Rating - Normal	820KW
Voltage Rating	600 (-15, +10%) V
Frequency Rating	60 (+ / - 5%) Hz

Standard Equipment Design Features

Special focus on ergonomics, noise, vibrations, chemical substances and products, illumination, indoor climate and outdoor operation.

Special Features Include:

- All components marked with individual numbers.
- Terminals marked with terminal number.
- IS and Non IS signals separated in blue and grey cable trays.



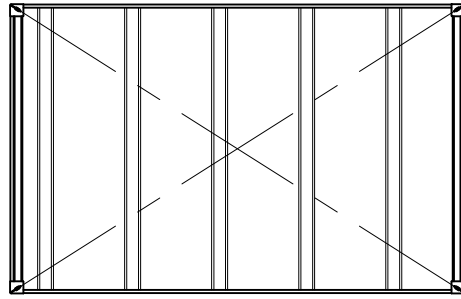

Top View

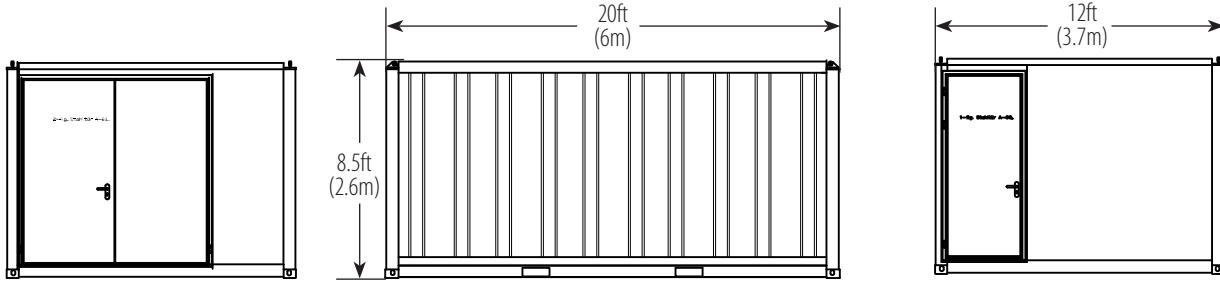

Rear Side

Platform down

Side View

Front Side

Interior View

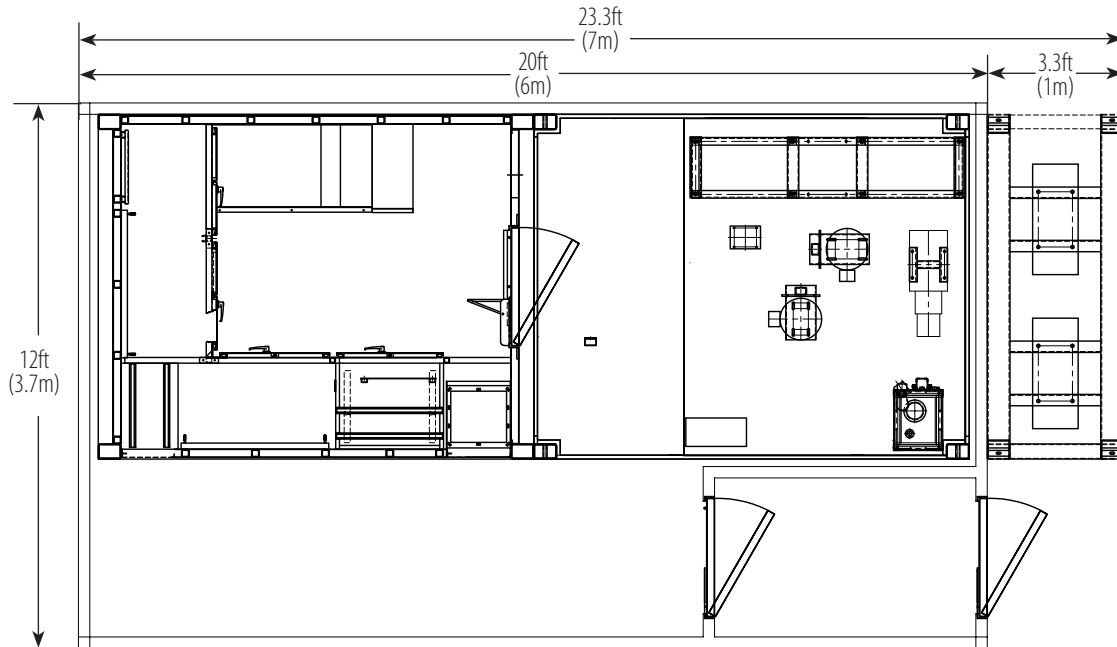

All specifications are subject to change without notice.

Asia Pacific

Jakarta, Indonesia
 Email: APBU_sales@tescoCorp.com

Latin America

Mexico City, Mexico
 Email: LABU_sales@tescoCorp.com

China

Chaoyang District, Beijing
 Email: CHINA_sales@tescoCorp.com

Middle East & Africa

Dubai, UAE
 Email: MABU_sales@tescoCorp.com

Europe/Russia

Moscow, Russia
 Email: EURO_sales@tescoCorp.com

United States / Canada

Houston, Texas / Calgary, Alberta
 Email: NABU_sales@tescoCorp.com

